



# Multi-Purpose C-Band (INSAT) Receive Filter

## Model 18663

This versatile receive filter rejects the extended (INSAT) transmit band (6.725 - 7.025 GHz), and **also rejects** transmissions from *other potential sources of interference*.

Ideal for use in high-density transmit paths, the model **18663** provides excellent rejection of these *other* bands:

<b>Maritime Radionavigation</b> .....	3 - 3.1 GHz
<b>Radar</b> .....	3.1 - 3.45 GHz
<b>WiMAX</b> .....	3.4 - 3.8 GHz
<b>X-band</b> .....	7.25 - 8.4 GHz
<b>Maritime &amp; Aeronautical Radionavigation</b> .....	9 - 11 GHz



- *Very low Insertion Loss = Minimal Signal Degradation.*
- *Ideal for INSAT and other Extended C-band Applications.*
- *Easily bolt-on installation and no power supply required.*

### Specifications:

Passband:	4.5 - 4.8 GHz
Passband Loss:	0.2 dB Max
Passband VSWR:	1.22:1 Max
Rejection:	80 dB Min from 1 - 3.9 GHz 20 dB Min from 3.9 - 4.3 GHz 70 dB Min from 5.4 - 5.85 GHz 80 dB Min from 5.85 - 12 GHz
Flanges:	CPR229G
Dimensions:	6.36" x 3.88" x 2.75" (162 mm x 98 mm x 70 mm)
Finish:	Gloss White Lacquer

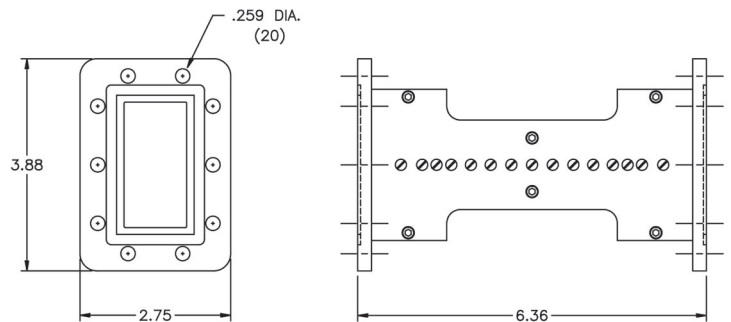

[Request A Quote](#)